

Evaluation Report CCMC 13099-R SUPERSEAL Dimpled Membrane (Dampproofing), SUPERPRO Dimpled Membrane (Dampproofing)

MASTERFORMAT:	07 11 19.01
Evaluation issued:	2003-01-23
Re-evaluated:	2015-04-14
Revised:	2018-07-13

1. Opinion

It is the opinion of the Canadian Construction Materials Centre (CCMC) that “SUPERSEAL Dimpled Membrane (Dampproofing), SUPERPRO Dimpled Membrane (Dampproofing)”, when used as dampproofing for basement walls in accordance with the conditions and limitations stated in Section 3 of this Report, complies with the National Building Code 2010:

- Clause 1.2.1.1.(1)(b), Division A, as an alternative solution that achieves at least the minimum level of performance required by Division B in the areas defined by the objectives and functional statements attributed to the following applicable acceptable solutions:
 - Sentence 9.13.2.2.(1), Material Standards

This opinion is based on CCMC’s evaluation of the technical evidence in Section 4 provided by the Report Holder.

Ruling No. 09-29-227 (13099-R) authorizing the use of this product in Ontario, subject to the terms and conditions contained in the Ruling, was made by the Minister of Municipal Affairs and Housing on 2009-11-27 (revised on 2017-03-31) pursuant to s.29 of the Building Code Act, 1992 (see Ruling for terms and conditions). This Ruling is subject to periodic revisions and updates.

2. Description

The products are black or brown high-density polyethylene, quasi-rigid plastic sheet membrane extruded in a manner that results in a smooth surface on one side and a dimpled surface on the other. The dimpled surface provides an air gap between the concrete wall and the adjacent soil.

The products are available in rolls that are 20 m long with sheets that are 0.635 mm thick and up to 4 m wide.

To ensure correct application, the products must be installed as part of the dampproofing system with appropriate accessories such as fasteners, washers and moulding strips, as recommended by the manufacturer.

Installation details are shown in Figures 1 and 2.

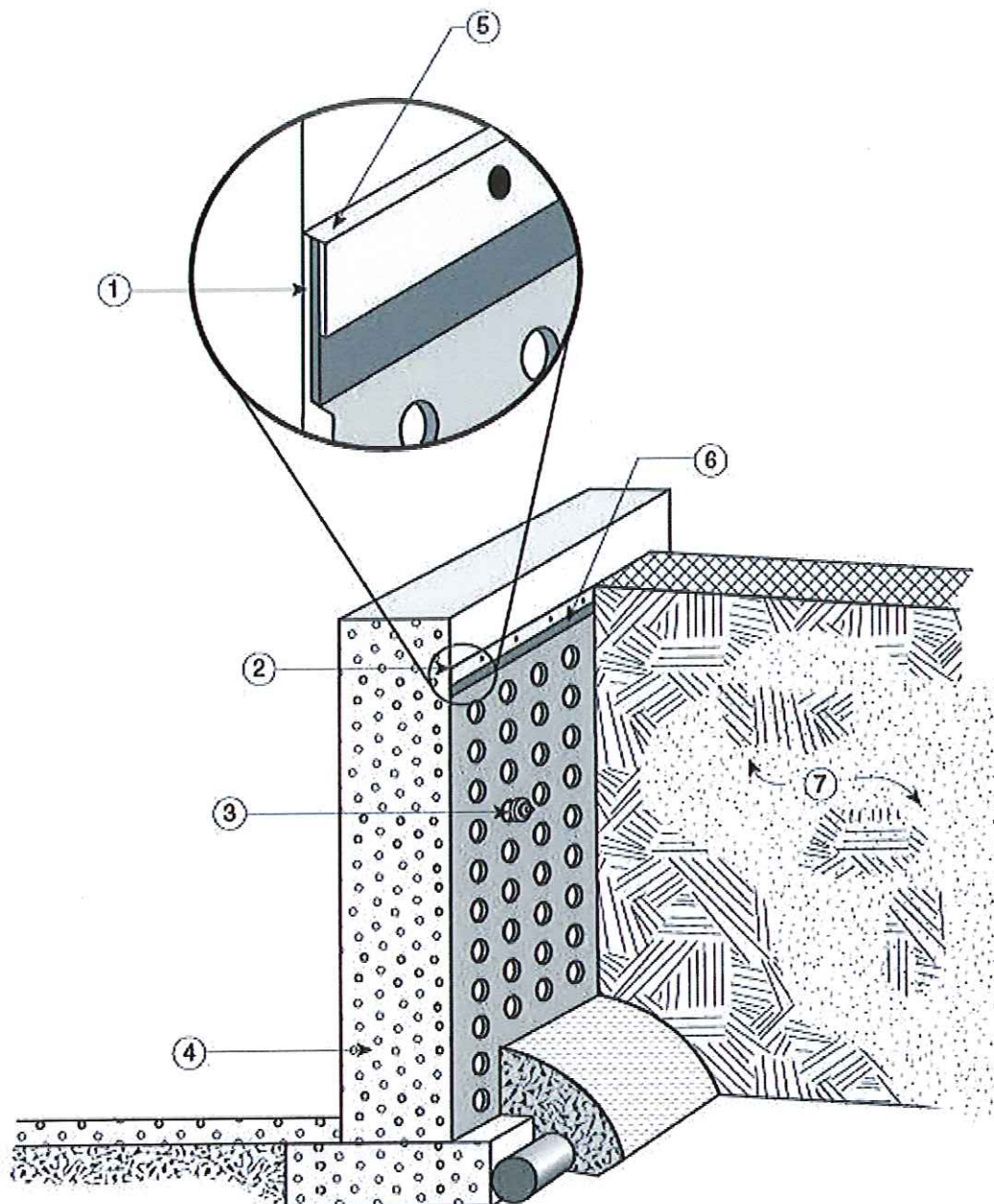

Figure 1. Installation details of the products (front view)

1. apply appropriate amount of caulking
2. caulking (behind membrane)
3. fastener
4. concrete foundation
5. rest moulding lip over tab or membrane edge
6. terminator bar
7. backfill

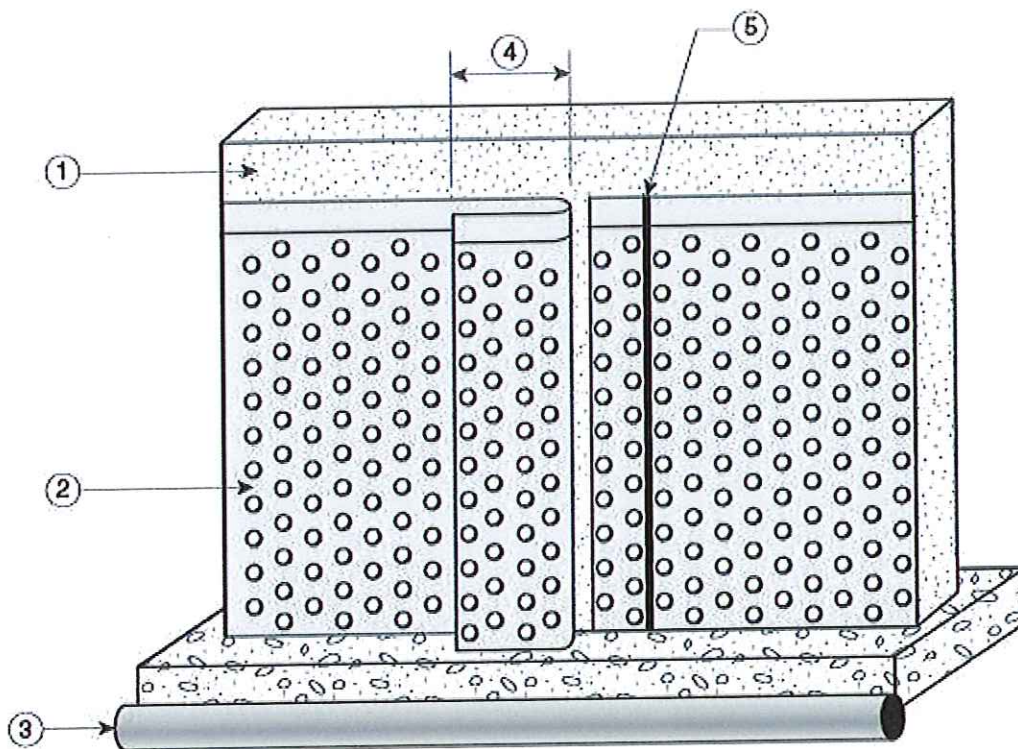

Figure 2. Installation details of the products (side view)

1. concrete foundation
2. membrane
3. drainage tile
4. minimum 152.4-mm overlap
5. caulking

3. Conditions and Limitations

CCMC's compliance opinion in Section 1 is bound by the "SUPERSEAL Dimpled Membrane (Dampproofing), SUPERPRO Dimpled Membrane (Dampproofing)" being used in accordance with the conditions and limitations set out below.

- The products were evaluated for use against cast-in-place and concrete block foundations only.
- The products must be used in locations where the foundation wall is well drained in accordance with Subsection 9.14.2., Foundation Drainage, of Division B of the NBC 2010.
- The products must be installed in accordance with the manufacturer's instructions and be protected from exposure to ultraviolet radiation from the sun within 30 days.
- The products are evaluated for use in depths up to 3.7 m below grade. Application depths greater than 3.7 m are considered to be outside the scope of this Report.
- The products must cover the foundation wall from the top of the footing to the final grade.
- The top of the membrane and all vertical joints and terminations must be mechanically fastened and sealed to prevent soil particles from entering behind the membrane.
- As the dampproofing membrane does not have to adhere to the surface and can permanently bridge any normal joint, tie hole, fault or shrinkage crack, the wall surface does not have to be parged, cleaned, patched or sealed before hanging the membrane.
- The products have been evaluated for use as a foundation wall drainage material. For details, see CCMC 13098-R.
- The products' label and/or packaging must be clearly identified with the following:
 - manufacturer's name or logo; and
 - the phrase "CCMC 13099-R".

4. Technical Evidence

The Report Holder has submitted technical documentation for CCMC's evaluation. Testing was conducted at laboratories recognized by CCMC. The corresponding technical evidence for this product is summarized below.

4.1 Performance Requirements

Table 4.1.1 Results of Testing of the Performance Requirements for the Products

Properties		Requirements	Results	
			Black membrane	Brown membrane
Thickness (mm)		Report	0.635	0.635
Weight (g/m ²)		≥ 500	732	640
Impact load		min. 12 of 15 must pass a rating of 3	15 of 15 passed	15 of 15 passed
Static puncturing		min. 5 of 6 must pass a rating of 3	6 of 6 passed	6 of 6 passed
Cold bending		No visible cracking	No visible cracking	No visible cracking
Water vapour permeance (ng/Pa·s·m ²)		≤ 37.2	4.66	4.29
Original ¹	tensile strength at yield (kN/m)	≥ 8	13	15
	elongation at break (%)	≥ 25	930	911
Water immersion ¹	tensile strength at yield (%)	≥ 80 of original	116	104
	elongation at break (%)	≥ 70 of original	105	94
Heat aging ¹	dimensional change (%)	≤ ±1	0	0
	weight change (%)	≤ 0.10	−0.06	−0.05
	tensile strength at yield (%)	≥ 80 of original	130	108
	elongation at break (%)	≥ 70 of original	105	107
Chemical attack exposure	ammonium chloride	tensile strength at yield (%)	107	98
		elongation at break (%)	105	128
	sodium sulfate	tensile strength at yield (%)	111	101
		elongation at break (%)	105	128
Compressive strength (kN/m ²)		≥ 100	335	290

Note to Table 4.1.1:

- ¹ It was deemed through analysis and testing that the products' tensile and elongation properties are not dependent on the orientation of the product samples, i.e., machine or cross direction.

Report Holder

SUPERSEAL Basement Systems Ltd.
PO Box 61646 Brookwood RPO
Langley, BC V3A 8C8

Telephone: 800-571-1877
Fax: 604-576-2458
Email: ted@superseal.ca
Web: www.superseal.ca

Plant(s)

Haiterbach, Germany

Disclaimer

This Report is issued by the Canadian Construction Materials Centre, a program of NRC Construction at the National Research Council of Canada. The Report must be read in the context of the entire CCMC Registry of Product Evaluations, including, without limitation, the introduction therein which sets out important information concerning the interpretation and use of CCMC Evaluation Reports.

Readers must confirm that the Report is current and has not been withdrawn or superseded by a later issue. Please refer to http://www.nrc-cnrc.gc.ca/eng/solutions/advisory/ccmc_index.html, or contact the Canadian Construction Materials Centre, NRC Construction, National Research Council of Canada, 1200 Montreal Road, Ottawa, Ontario, K1A 0R6. Telephone (613) 993-6189. Fax (613) 952-0268.

NRC has evaluated the material, product, system or service described herein only for those characteristics stated herein. The information and opinions in this Report are directed to those who have the appropriate degree of experience to use and apply its contents. This Report is provided without representation, warranty, or guarantee of any kind, expressed, or implied, and the National Research Council of Canada (NRC) provides no endorsement for any evaluated material, product, system or service described herein. NRC accepts no responsibility whatsoever arising in any way from any and all use and reliance on the information contained in this Report. NRC is not undertaking to render professional or other services on behalf of any person or entity nor to perform any duty owed by any person or entity to another person or entity.

Date modified:
2017-10-12